

SINGLE BEAM ACTIVE INFRARED DETECTOR

Brief Introduction

Single beam active intruder infrared detector with built-in AGC control circuit. Can effectively prevent sunlight.

Beautiful structure, small size, easy to install, Totally-sealed rainproof and mothproof design. Can be widely used for access control system, parking lot, defence wall, door and window, balcony, garage, passage and other places.

1. Structural Figure

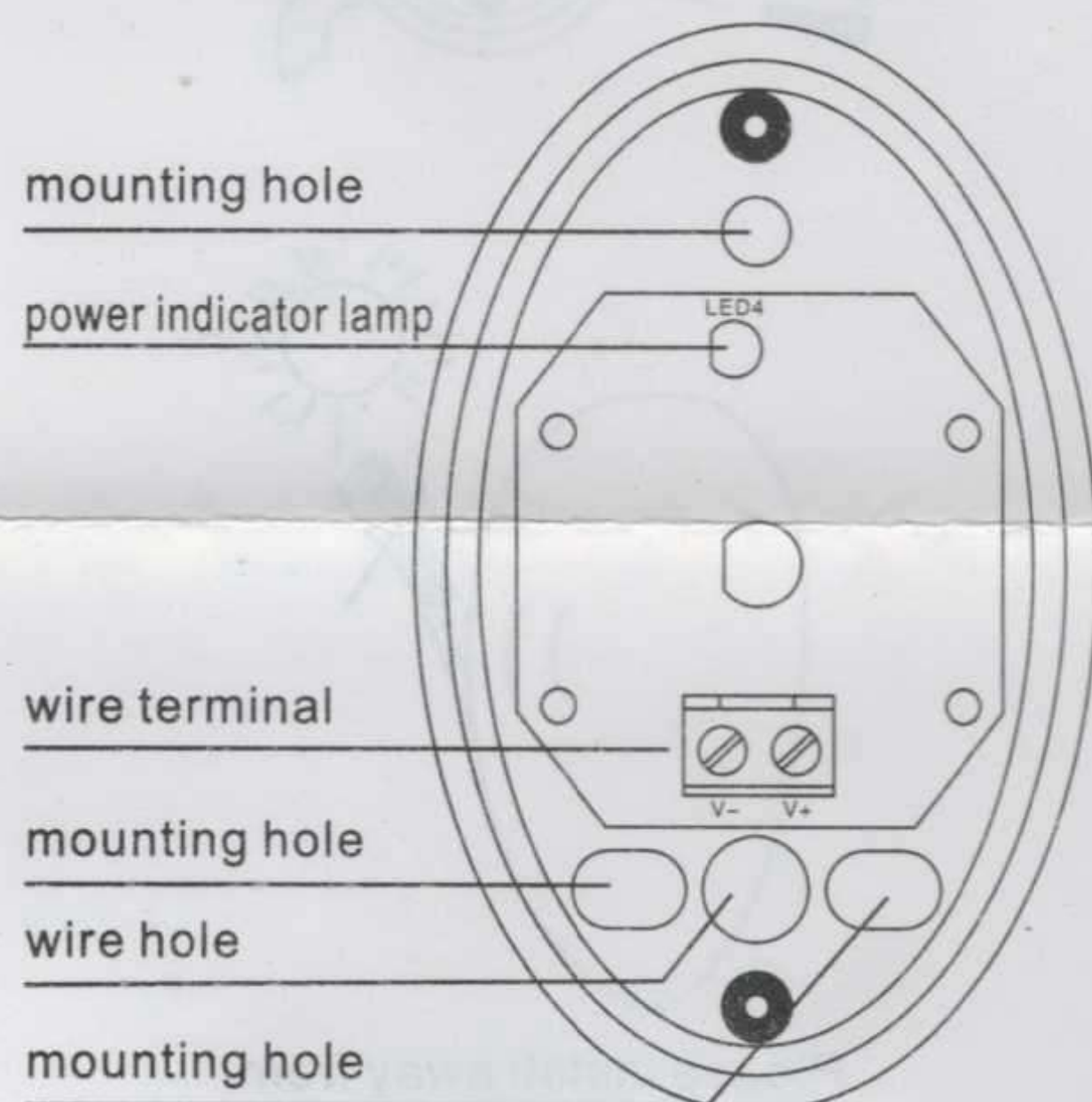

Transmitter

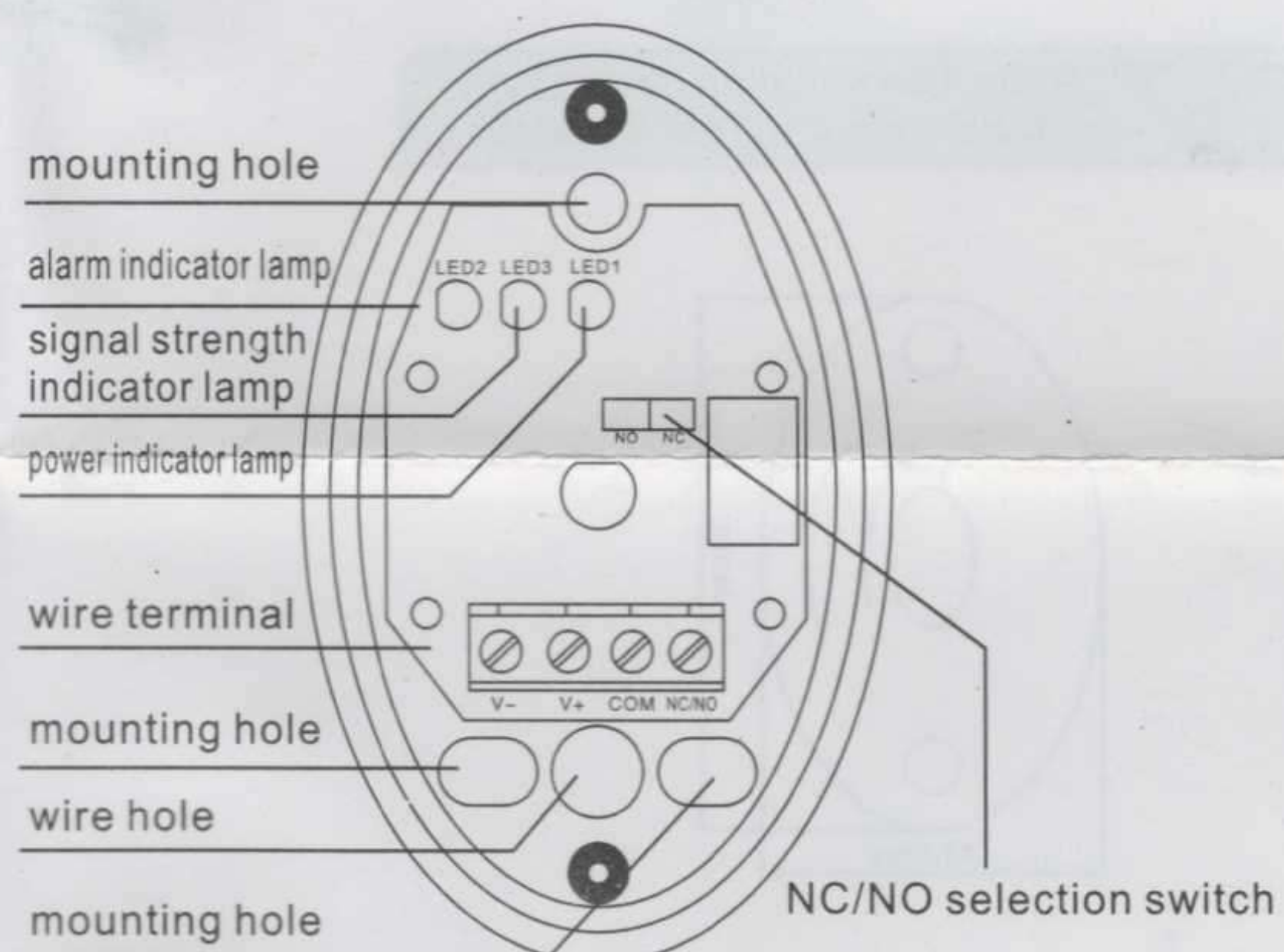

Receiver

2. Wiring Diagram

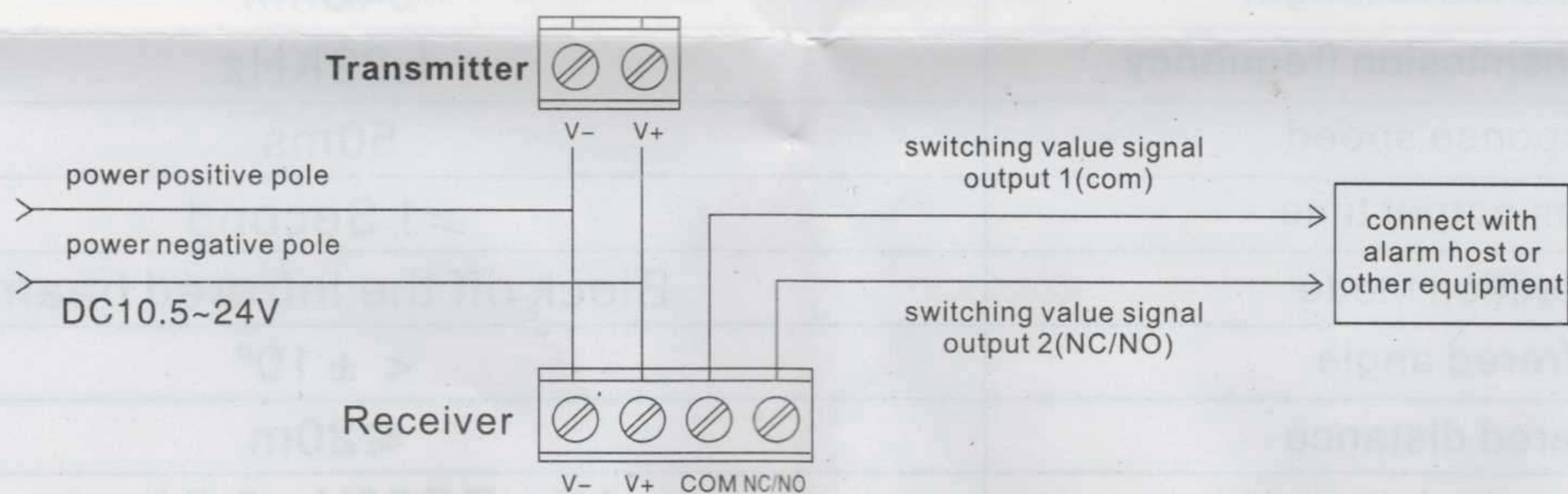

NOTE

To ensure the stability of the detector, Don't use inferior nonlinear switching power supply

3. Installation Instruction

The optimal installation height should be higher than 20m. the product should be vertical when install and make sure the transmitter and receiver be at the same level. LED1&LED4 are power indicator lamps. LED2 is alarm indicator lamp, LED3 is signal strength indicator lamp(LED3 on indicates adjustment is complete)

Note: Since the transmitting power of this product is large, the signal will be very strong if the transmitter is too close with the receiver, so please make the distance at least 1 meter between the transmitter and receiver, then try again. when the installation distance is very close, remove the spectral lens to enhance the sensitivity

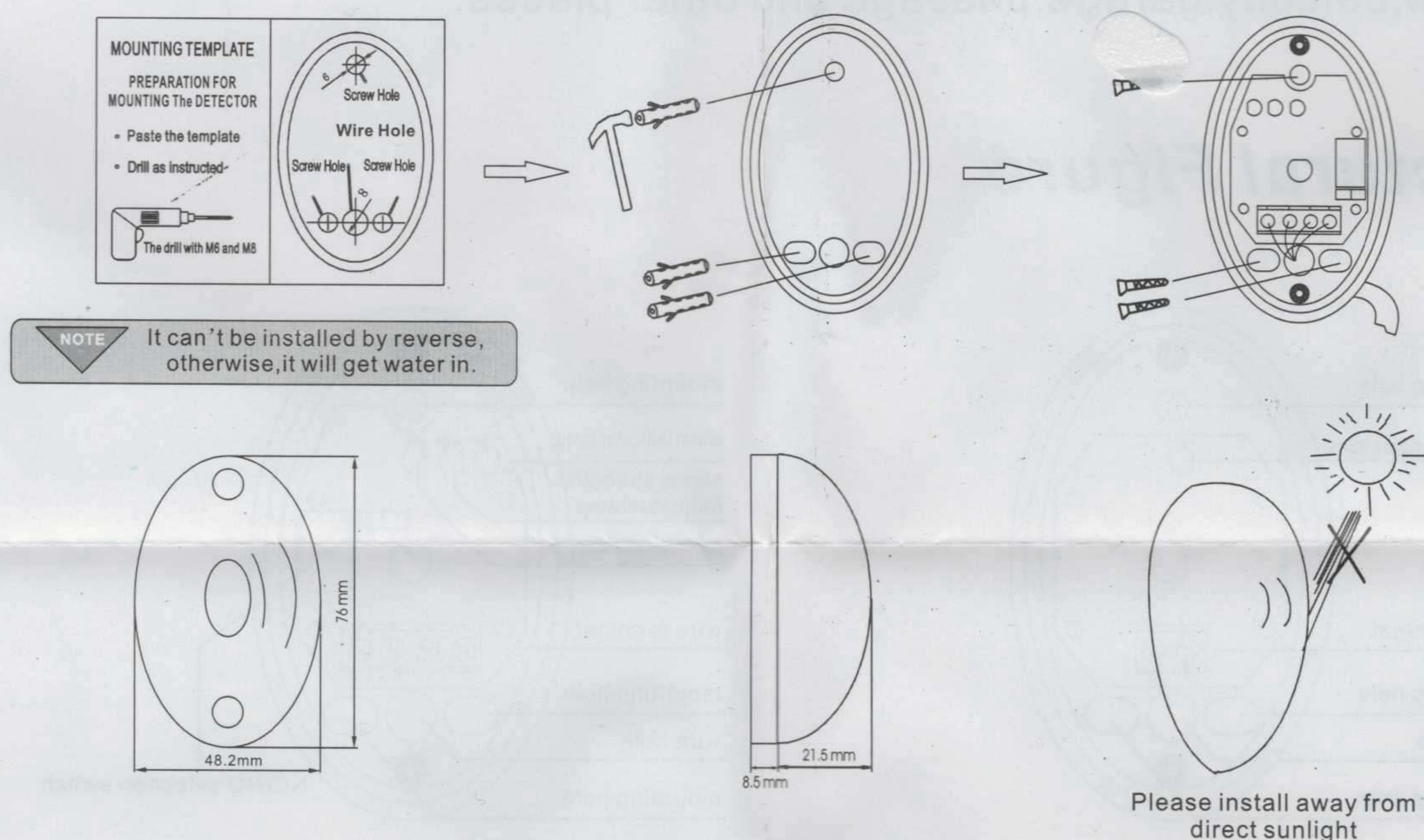

4. Technical Parameter

Power supply	DC 10.5V~24V/0.5A
Maximun current	TX:15maMAX RX:30maMAX
Optical source	Infrared Pulse
Infrared Wave length	940nm
Infrared transmission frequency	1.92KHz
Response speed	50ms
Alarm output time	≥1 Second
Detection mode	Block off the infrared beam
Infrared angle	< ± 10°
Infrared distance	≤20m
Relay contact capacity	AC、DC30V、0.5Amax
Working environment	Temperature:-25°C~+55°C Humidity:RH 95%
Product dimension	76x48.2x30(mm)